

## 28 631 LG0 RELEXA PORTA SAPONE

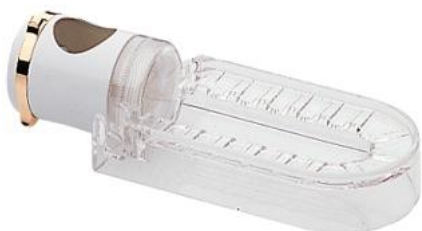

### DESCRIZIONE PRODOTTO

- per aste doccia 28 620/28 621
- finitura GROHE Long-Life

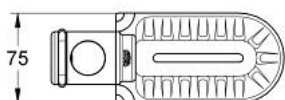
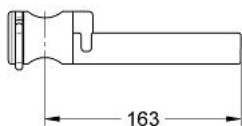

## 28 631 LG0 RELEXA PORTA SAPONE

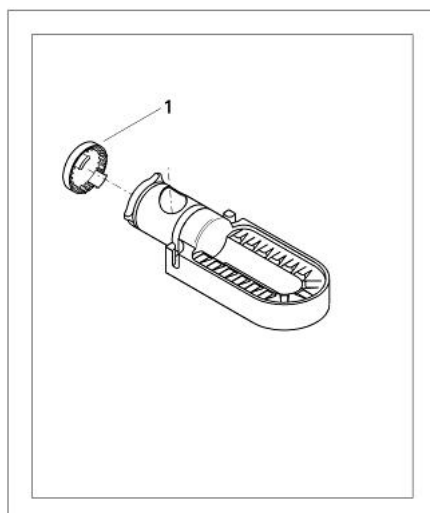

**PARTIDIRICAMBIO** , gennaio 1991 – now

1: Cappuccio di copertura (Ordine n. 45652L00)