

41 199 000 **WALL-INSTALLATION WASHING MACHINE /
DISHWASHER SIPHON 1/2"**

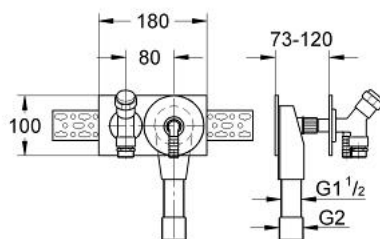

DESCRIZIONE PRODOTTO

- Colour: cromo
- grease chamber headpart 1/2" for closable hose connection with non-return valve
- pipe-ventilating valve of type C construction
- built-in siphon 1 1/2" / 2"
- piastra di copertura in acciaio inox
- 180 x 100 mm
- con valvola di ritegno incorporata
- finitura GROHE Long-Life

41 199 000 **WALL-INSTALLATION WASHING MACHINE /
DISHWASHER SIPHON 1/2"**

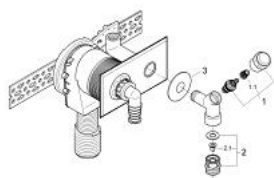

PARTIDIRICAMBIO , gennaio 2002 – now

1: Vitone da 1/2" (Ordine n. 41818000)

1.1: Inserto a scatto (Ordine n. 4184200M)

2: Insert (Ordine n. 41833000)

2.1: Cono (Ordine n. 41835000)

3: Rosetta (Ordine n. 41841000)